

LTR	ECO #	RELEASE DATE	BY

Installing the 418001 Rack Mount Kit Tools required: #1 and #2 Phillips screwdrivers
Flat blade screwdriver is optional if removing feet from bottom cover.

Precautions:

1. Disconnect the power cord from the 8000 Series meter.
2. It is recommended to use ESD precautions (wrist strap, ESD mat etc.) when installing this kit. If such measures are not available, only handle the meter by the external metal chassis parts. Do not touch the circuit boards or other internal components when the case is open to prevent electro-static damage to the circuitry.
3. Be careful when removing or re-installing covers to prevent scratching paint, especially at the front bezel and on the side panels.
4. **To prevent overheating and possible damage:** Adequate airflow must be provided to the vents on the bottom panel of the meter to maintain specified accuracy and prevent damage. Do not block these vents when installing unit in your rack. Leaving at least 1 blank rack panel space below the meter is strongly recommended.

Installation: -see accompanying photos below

1. Remove the 2 screws from the rear of the top and bottom cover panels (4 screws total).
2. Carefully tilt the top cover upward at the rear about 3" as shown in Photo 1, then move it toward the rear of the meter while lifting it upward to disengage the lip at the front of the meter.
3. Turn the meter over and remove the bottom cover in the same manner.
4. The feet may be removed from the bottom panel at this time if necessary. **Do not block airflow to the bottom panel vent slots by mounting the meter directly on top of other equipment.**
5. Remove the screws holding the corner plastic pieces and remove the corner pieces.
6. Using the 6-32 x 1/2" pan head screws, install the 4 plastic spacers. There are 2 types of spacers; one for the top left / bottom right and the other for the top right / bottom left. The spacers in the photo are shown in brown color and circled for easier identification. (Photo 4)
7. Using the 8-32 x 3/8" flat head screws, attach the handles to the angle brackets as shown. Assemble them as mirror images of each other; one for left side and one for right side.
8. Attach the angle brackets to the meter as shown using the screws removed from the plastic corner pieces on the front, and the newly supplied 6-32 x 3/8" pan head screws with the star washer on the sides.
9. The kit may be installed with the extender plate on either side of the meter. Place the side of the extender plate which has the threaded inserts behind the desired rack ear bracket and attach using the M6 x 12mm screws.
10. Reassemble covers being careful to avoid scratching paint, especially on the side rails and front bezels in areas shown in Photo 1.



DRN	01-29-14 LNP
APPD	09-26-14 JRB
QA APD	09-26-14 AC
REL	09-26-14 LNP

PAGE 1 of 4

TITLE Installation Instructions for
8000 Series Rack Mount Kit

DWG. NO. UN-01-272

REV.
-

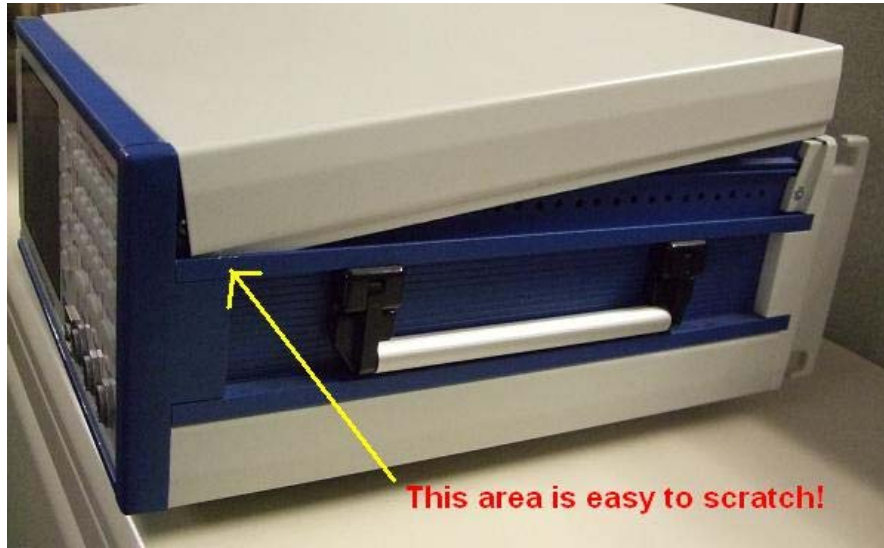

Photo 1 - Cover removal

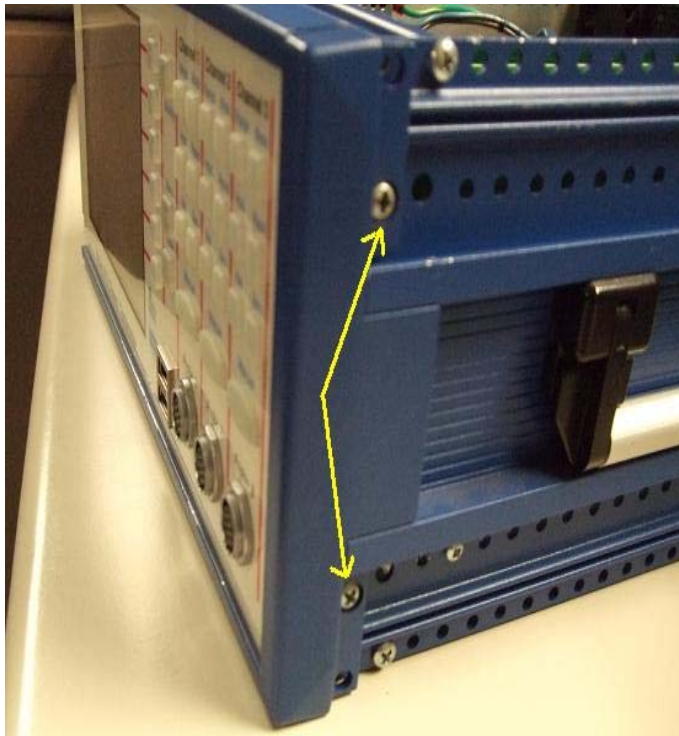

Photo 2 - Corner piece screw removal



Photo 3 - Corner piece removed



Photo 4 - Spacers Installed on case



Photo 5 - Handle installed on Rack Bracket



Photo 6 - Side screws w/star washer in bracket



Photo 7 - Front screws in bracket



Photo 8 - Extender plate installed (right side option shown, plate may be installed on left side if desired)